

VCD-6351P-BL/WT

W-5 Camera



▲ VCD-6351P-BL



▲ VCD-6351P-WT

[Features]

- SONY 1/3" Super HAD II High Sensitivity Color CCD (Enhanced CCD)
- High Resolution : 600TVL
- Min. Illumination : 0.15Lux 40IRE
- Sens-Up (2x~512x)
- Vari-Focal Auto Iris Lens (2.8mm~11mm)
- Digital Day & Night for surveillance 24 hours
- Next Generation DNR(2D + 3D) for saving storage
- SDDR function
- HLC (High Light Compensation)
- Private Masking (12 zones)
- Motion Detection (8 zones)
- Multi-languages OSD
- Flexible backlight compensation by zone selection
- Digital Zoom (16x)
- Wall or Ceiling mounting through internal 3-Axis Gimbal
- Easy operation by on screen display

[Dimensions]

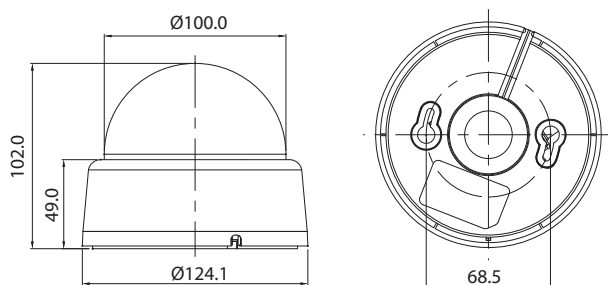

Design and specifications are subject to change without notice.

[Specifications]

ITEM	VCD-6351P-BL/WT
Power Consumption	12VDC Only (Max.160mA)
Image Sensor	SONY 1/3" Super HAD II High Sensitivity Color CCD
Total Pixels	NTSC : 811(H) x 508(V) PAL : 795(H) x 596(V)
Effective Pixels	NTSC : 768(H) x 494(V) PAL : 752(H) x 582(V)
Scanning System	2:1 Interlace
Synchronization	INT / LL
Frequency	NTSC : Horizontal : 15.734 KHz, Vertical:59.94 Hz PAL : Horizontal : 15.625 KHz, Vertical:50.00 Hz
H.Resolution	600 TV lines
S/N	52dB (AGC Off, Weight ON)
Min. Illumination	0.15Lux
White Balance	ATW / AWC / MANUAL(1700°K ~11,000°K)
Shutter Speed	1/60,1/50 ~ 1/120,000 sec
Sens-up	AUTO / OFF (Selectable x2 ~ x512)
Gain Control	LOW / HIGH / OFF
DNR	ON / OFF (1~32 Level)
Motion Detection	ON / OFF (8 Zone)
Privacy Function	ON / OFF (12 Zones)
V-REV	ON / OFF
H-REV	ON / OFF
Freeze	ON / OFF
Sharpness	ON/OFF (Level Adjustable)
Day & Night	COLOR / Black&White / AUTO
Digital Zoom	ON / OFF (x16)
Operating temperature / Humidity	-10°C to + 50°C / 30% to 80% RH
Storing Temperature / Humidity	-20°C to + 60°C / 20% to 90% RH