

HD-SDI Cameras & Domes

GBR-FB02 Base for GCH-KxxxxV series

GBR-FB02.72.1.05.07.2012
© ASP AG



3. Installation

Mark the screwing holes with the included Mounting Template and drill the holes.

Connect the Sponge Base and the Junction Box as shown in the drawing to the wall/ceiling.

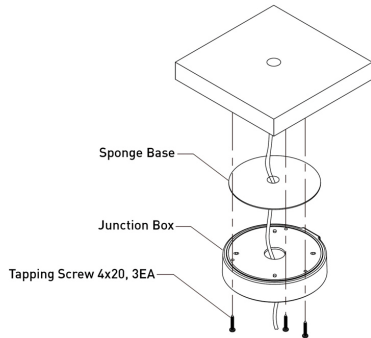

Make sure the cables are freely led through the Junction Box as shown in the drawing and that all screws are fixed tightly.

Connect the Camera to the Junction Box as shown in the drawing.

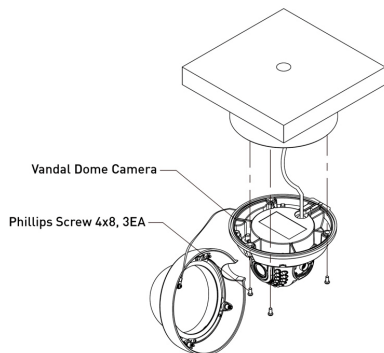

Content:

1. Introduction	1
2. Package Contents & Needed Items	1
3. Installation	2

1. Introduction

The GBR-FB02 can be used as a Junction Box for GCH-K0323V & GCH-K0326V. If you need to place additional technology near the camera or cannot put the cable behind the wall, this Junction Box will help you to install the camera.

2. Package Contents & Needed Items

These parts are included:

- Junction Box
- Sponge Base
- 4x Tapping Screw 4x20
- 4x Phillips Screw 4x8
- Installation Instructions
- Mounting Template

Tools needed:

- Tool for drilling
- Phillips Screw Driver

Specifications GBR-FB02

Suitable for	GCH-K0323V, GCH-K0326V
Body material	Die cast aluminium
Colour	Shiny white
Weight	0.350 kg
Dimensions (wtxhxd)	Ø 150.5 X 35.7 mm

Dimensions

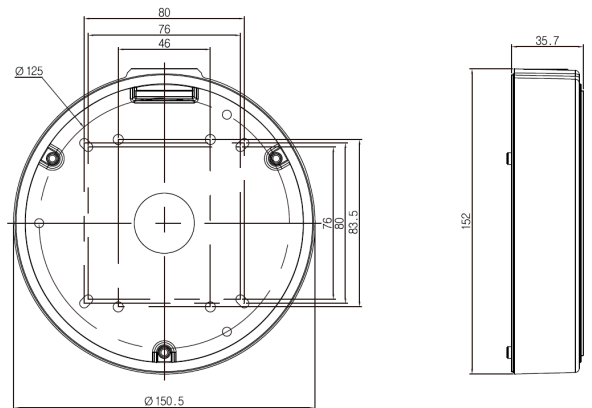

Attention:

Please do not make any page size adjustments in the printer settings when printing this Mounting Template.

